

EP 型 / EP Core

型号 TYPE	图例 FIG.	尺寸 Dimensions (mm)						
		A	B	C	D	E	F	G
EP5F	1	6±0.15	2.9+0.05/-0.1	3.9+0/-0.25	1.7±0.1	4.3min	2.1±0.1	
EP6/6.2/3.8C	1	6±0.15	3.1±0.1	3.8±0.1	1.7±0.1	4.575±0.125	2.325±0.125	
EP7K	1	9.2±0.2	3.7±0.2	6.4±0.2	3.3±0.1	7.2min	2.7±0.2	
EP9.5O	4	9.6+0/-0.6	5±0.1	10±0.3	3.1±0.15	7.3min	3.45±0.15	6.5±0.2
EP10.5/6.4/8.5	6	10.5±0.15	3.2±0.1	8.45±0.15	4.7±0.1	8±0.15	1.9±0.1	8.4±0.15
EP11/7/8.8A	7	11±0.2	3.75±0.1	8.8±0.15	4.3±0.15	9±0.25	2.5±0.15	
EP10	1	11.5±0.3	5.1±0.2	7.7±0.2	3.3±0.2	9.4±0.2	3.8±0.2	
EP12.5/12.8/8.8	1	12.5±0.3	6.42±0.15	8.79±0.2	4.35±0.15	10±0.3	4.65±0.15	2.35±0.1
EP13X	1	12.5±0.3	6.5±0.3	8.8±0.2	4.4±0.2	10.0±0.3	4.5+0.4/-0	
EP12.6/6.6/8.5L	8	12.6±0.3	3.2+0.15/-0	8.5±0.25	4.8+0.05/-0.1	10.2min	2.2±0.1	2.55±0.1
EP12.6/6.6/8.5M	9	12.6±0.3	3.2+0.15/-0	8.5±0.25	4.8+0.05/-0.1	10.2min	2.2±0.1	2.55±0.1
EP12.9/6.7/8.55A	10	12.9±0.3	3.32±0.12	8.55±0.2	4.9±0.1	10.5min	2.25±0.1	
EP12.9/6.7/8.8I	10	12.9+0.2/-0.3	3.32+0.15/-0.1	8.8±0.2	4.9±0.1	10.5min	2.25+0.15/-0.1	2.5±0.1
EP12.9/6.7/8.8J	10a	12.9+0.2/-0.3	3.32+0.15/-0.1	8.8±0.2	4.9±0.1	10.5min	2.25+0.15/-0.1	2.5±0.1
EP12.9/6.7/8.8K	10b	12.9+0.2/-0.3	3.32+0.15/-0.1	8.8±0.2	4.9±0.1	10.5min	2.25+0.15/-0.1	2.5±0.1
EP12.9/6.7/8.8L	10b	12.9+0.2/-0.3	3.37±0.1	8.8±0.2	4.9±0.1	10.5min	2.3+0.15/-0.1	2.5±0.1
EP12.9/6.7/8.8M	10b	12.9+0.2/-0.3	3.37±0.1	8.8±0.2	4.9±0.1	10.5min	2.3+0.15/-0.1	2.5±0.1
EP14.1/7.7/13.3	2	14.1±0.2	3.85±0.1	13.3±0.2	7.5±0.1	11.8±0.25		
EP14.7/13.4/9.5A	5	14.7±0.25	6.68±0.1	9.5±0.2	5.7±0.15	12.7±0.25	5±0.15	
EP17	1	18.1±0.4	8.4±0.4	11.3+0/-0.6	5.9+0/-0.4	12.0±0.4	5.5+0.4/-0	
EP18/16.8/11	1	18.1+0.4/-0.6	8.4±0.4	11+0.5/-0.3	5.7+0.2/-0.3	12±0.5	5.7±0.2	

C1	Ae	Le	Amin	Ve	AL(±25%)				重量 g /PRS
					TP4	TP4A	TP4W	TPW33	
3.17	2.97	9.41	2.27	27.97	340	340	370	380	0.60
3.87	2.99	11.58	2.27	34.60	330	340	360	370	0.44
1.44	10.29	14.78	8.55	152.09	960	1000	1080	1130	2.10
0.83	21.26	17.63	19.00	374.88	1800	1800	2000	2100	3.00
0.66	19.60	13.00	17.30	256.00	1900	1900	2100	2200	2.62
0.68	16.87	11.39	14.52	192.07	1700	1700	1900	1900	2.28
1.68	11.00	18.48	8.55	203.21	800	800	900	900	2.90
1.20	19.26	23.04	14.86	443.74	1200	1200	1400	1500	2.30
1.18	19.72	23.20	15.21	457.40	1600	1650	1800	1900	5.20
0.85	18.36	15.57	17.50	286.01	1800	1800	2000	2100	2.16
0.85	18.36	15.57	17.50	286.01	1800	1800	2000	2100	2.16
0.85	18.59	15.88	17.66	295.15	1800	1800	2000	2100	2.40
0.83	18.95	15.83	17.90	299.97	1800	1800	2000	2100	2.35
0.83	18.95	15.83	17.90	299.97	1800	1800	2000	2100	2.30
0.83	18.95	15.83	17.90	299.97	1800	1800	2000	2100	2.35
0.87	18.28	15.90	17.43	290.70	1700	1800	2000	2000	1.22
0.87	18.28	15.90	17.43	290.70	1700	1800	2000	2000	2.34
0.43	38.78	16.49	38.58	639.45	3800	3800	4300	4400	5.00
1.14	26.95	30.62	21.83	825.10	1500	1500	1800	1900	5.52
0.80	33.60	26.76	25.52	898.96	1900	1900	2200	2300	12.40
0.80	33.60	26.76	25.52	898.96	1900	1900	2200	2300	12.20

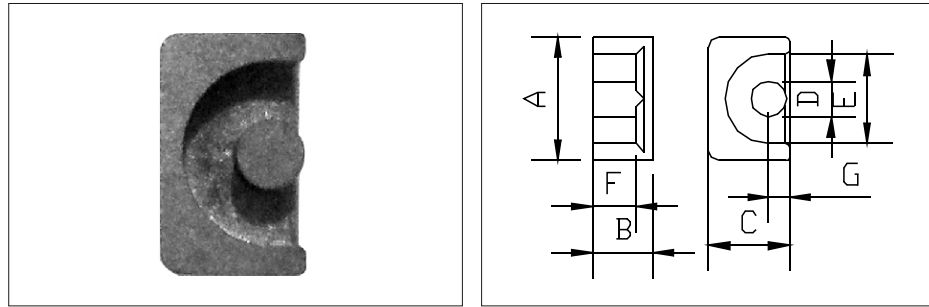

FIG.1

EP 型 / EP Core

型号 TYPE	图例 FIG.	尺寸 Dimensions (mm)						
		A	B	C	D	E	F	G
EP19.3/12.5/13.1	11	19.3±0.25	6.25±0.1	13.15+0.15/-0.2	7.3±0.1	16.3±0.25		6.65±0.1
EP20	1	24.0±0.5	10.7±0.2	15.0±0.4	8.8±0.3	16.5±0.4	7.2±0.2	

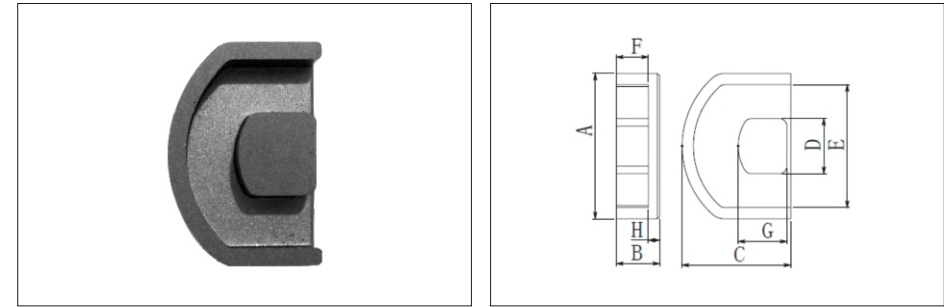

FIG.11

H	C1	Ae	Le	Amin	Ve	AL(±25%)				重量 g / PRS
						TP4	TP4A	TP4W	TPW33	
2±0.15	0.58	47.92	27.87	41.85	1335.53	3000	3100	3600	3700	8.50
	0.48	78.87	37.55	60.82	2961.33	3600	3700	4300	4600	33.00